

Form 8463, Revised
(1039)
Printed in U. S. A.

LIST OF PARTS



MACHINES
Nos. 81-3 and 81-4

THE SINGER MANUFACTURING COMPANY

INSTRUCTIONS FOR OILING

To ensure easy running and prevent unnecessary wear of the parts which are in movable contact, the machine requires oiling and when in continuous use, it should be oiled at least twice each day by applying Singer Cloth and Leather Oil to all oil holes marked "Oil" and to all other oiling places.

Copyright, U. S. A., 1926 and 1939
by The Singer Manufacturing Co.
All Rights Reserved for all Countries

INDEX

	Page
Accessories.....	14
Fittings.....	14
Foot Lifter Parts	15
Knee Lifter Parts.....	16
Knife Grinder.....	17
Machine Base.....	17
Machine No. 81-3.....	5
Machine No. 81-4.....	13
Numerical List of Parts.....	21
Obsolete Parts.....	19
Thread Unwinder.....	18
Welt Guide.....	18

INSTRUCTIONS FOR ORDERING

In ordering from this list, use ONLY the part NUMBER in the FIRST column.

The number stamped on a Sewing Machine Part is in every case the number of the single part only.

Every combination of parts sent out as such has its specific number, which, although not stamped on the parts, must be used when ordering the combination.

Each number always indicates the SAME PART in whatever list it appears, or for whatever machine.

The letters after some of the numbers indicate the style of finish only, as follows:

- A-Hardened, Polished, Nickel Plated and Buffed
- A.A-Buffed and Chromium Plated
- A.B-Hardened, Polished, Buffed and Chromium Plated
- B-Polished, Nickel Plated and Buffed
- C-Hardened Only
- C.R-Hardened and Merlized
- D-Polished Only
- E-Soft, Not Polished
- F-Hardened and Polished
- F.J-Hardened, Polished and Nickel Plated
- G-Bright Rumbled and Nickel Plated
- H-Blued
- J-Nickel Plated Only
- K-Hardened and Nickel Plated
- L-Brass Plated
- M-Oxidized
- N-Japanned, Dull
- P-Japanned, Bright
- P.P-Wrinkle Finish
- R-Merlized
- S-Cadmium Plated
- T-Copper Plated
- T.A-Hardened, Polished, Copper and Nickel Plated and Buffed
- T.B-Copper and Nickel Plated and Polished
- T.J-Copper and Nickel Plated Only
- T.K-Hardened, Copper and Nickel Plated
- T.L-Copper and Brass Plated
- T.M-Copper Plated and Oxidized
- U-Zinc Plated
- V-Silver Plated
- W-Polished and Nickel Plated
- X-Black Oxide, for Iron and Steel
- X.C-Hardened and Black Oxide, for Iron or Steel
- Y-Black Nickel Plated Only
- Z-Chromium Plated
- Z.A-Hardened, Polished, Nickel Plated, Buffed and Chromium Plated
- Z.B-Polished, Nickel Plated, Buffed and Chromium Plated
- Z.C-Hardened and Chromium Plated
- Z.D-Polished and Chromium Plated
- Z.G-Bright Rumbled, Nickel Plated, Bright Rumbled and Chromium Plated
- Z.J-Nickel and Chromium Plated
- Z.T-Copper and Chromium Plated

These letters MUST BE USED when they appear in the list; and AFTER the number as in the list.

In this series:

- 1 to 1500, 50001 to 51500 and 140001 to 142000 are Screw Numbers
- 1501 to 1800 and 51501 to 51800 are Nut Numbers
- 1901 to 2000 and 51801 to 52000 are Roller Numbers
- 2001 to 50000 and 52001 to 140000 and 142001 to 190000 are Sewing Machine Parts, 190001 and upward are numbers of Electrical Parts.

The figures in the second column refer only to the plates, illustrating the parts, and are NOT TO BE USED in ordering.

Parts marked with an asterisk (*) are furnished only when repairs are made at factory.

LIST OF PARTS COMPLETE FOR

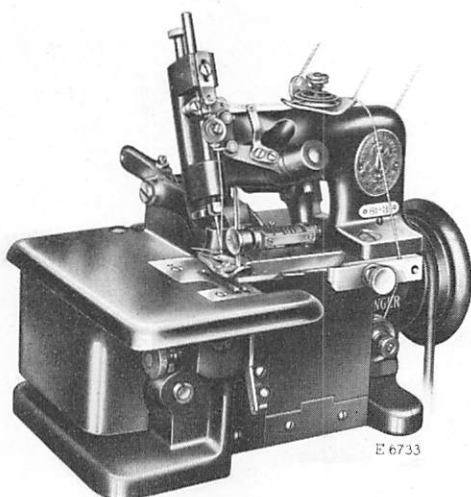

MACHINE No. 81-3

FOR TRIMMING AND OVEREDGING FABRICS.
ONE NEEDLE, ONE LOOPER, TWO-THREAD
STITCH, BIGHT ADJUSTABLE FROM
 $\frac{1}{8}$ in. to $\frac{3}{16}$ in. AUXILIARY FEED TO
PREVENT PULLING. SPEED 3300 R. P. M.

No.	Plate	Name
*42484	-----	Arm with two each 462C, 624C, 42253 and 42487.....
4389	23047	Arm Dowel Pin.....
949E	23047	" Screw.....
42001	23047	Balance Wheel, 2 $\frac{3}{16}$ in. pulley, with 424C and 1354C.....
1354C	23047	Balance Wheel Position Screw.....
424C	23047	" " Set Screw.....
*42145	-----	Cloth Plate.....
42003	23048	" " Extension (lower).....
229E	23048	" " " " Screw.....
42108	23048	" " " (upper).....
229E	23048	" " " " Screw.....
42005	23048	" " Lock Spring.....
236C	23048	" " " " Screw.....
42146	23048	Cloth Plate complete, Nos. 42003, 42005, 42108, 42145, two 236C and five 229E
1437D	23048	Cloth Plate Hinge Screw.....
1655E	23048	" " " " Nut.....

PARTS FOR MACHINE No. 81-3

No.	Plate	Name
42147	23049	Feed (back) Bar.....
61C	23049	" " " Hinge Screw.....
42148	23049	" " Connecting Link.....
1132C	23049	" " " " Hinge Screw.
42149	23049	Feed (back) Dog, 3 teeth (16 teeth to the inch) for 42163.....
203D	23049	Feed (back) Dog Screw.....
42150	23049	" " Regulator.....
1132C	23049	" " " Hinge Screw.....
190D	23049	" " " Set Screw.....
1444C	23049	" " " Thumb Screw.....
42151	23049	" (front) Bar with 1253C.....
42007	23049	" " " Hinge Pin.....
1253C	23049	" " " " " Set Screw....
42008	23047	" " Connecting Rod with two 1057C.....
42371	-----	Feed (front) Connecting Rod 42008 with 1373C and 1520C.....
1057C	23047	Feed (front) Connecting Rod Cap Screw...
1373C	23047	" " " " Hinge Screw.
1520C	23047	" " " " " " "
		Nut.....
42152	23049	Feed (front) Dog, 17 teeth (16 teeth to the inch) for 42163.....
190D	23049	Feed (front) Dog Screw.....
42011	23047	" " Eccentric with two 453C....
42153	23053	" " " Cover.....
207D	23053	" " " " Screw.....
453C	23047	" " " Set Screw.....
42012	23047	" " Lifting Eccentric with two 462C.....
42013	23047	Feed (front) Lifting Eccentric Connection.....
462C	23047	Feed (front) Lifting Eccentric Set Screw
1374C	23049	Feed (front) Regulating Screw Stud.....
1680C	23049	" " " " " Nut..
42290	23049	" " " " " Washer
42014	23049	" " Regulator with two each 233J and 1259C.....
42015	23049	Feed (front) Regulator Connection with 1012E.....
42368	-----	Feed (front) Regulator Connection 42015 with 1373C and 1520C.....
1012E	23049	Feed (front) Regulator Connection Adjusting Screw.....
1373C	23049	Feed (front) Regulator Connection Hinge Screw.....
1520C	23049	Feed (front) Regulator Connection Hinge Screw Nut.....
42016	23049	Feed (front) Regulator Hinge Stud.....
42017	23049	" " " Indicator.....
42018	23048	" " " " Plate..

No.	Plate	Name
337D	23048	Feed (front) Regulator Indicator Plate Screw.....
207D	23049	Feed (front) Regulator Indicator Screw..
1259C	23049	" " " Set Screw.....
233J	23049	" " " Stop Screw.....
42154	23049	" " Rock Shaft.....
42155	-----	Feed (front) Rock Shaft complete, Nos. 42021 and 42154.....
42021	23049	Feed (front) Rock Shaft Crank with 157E.
157E	23049	" " " " " Clamping Screw.....
42098	23049	Feed (front) Rock Shaft Hinge Pin.....
42079	23049	" " " " " " Bushing
1036C	23049	" " " " " " " Set Screw.....
*42022	-----	Frame.....
42023	23047	" Rotary Shaft.....
42024	23047	" " " Bushing (front).....
1036C	23047	" " " " " Set Screw.....
42025	23047	Frame Rotary Shaft Crank with 1259C and 1375C.....
1375C	23047	Frame Rotary Shaft Crank Position Screw.
1259C	23047	" " " " " Set Screw.....
42026	23047	" " " Flanged Bushing (back) with 54967.....
54967	23047	Frame Rotary Shaft Flanged Bushing (back) Oil Pad (braided cotton).....
1036C	23047	Frame Rotary Shaft Flanged Bushing (back) Set Screw.....
42367	23047	Frame Rotary Shaft Front Bearing Oil Pad (braided cotton).....
132560	23048	Frame Side Cover (left) with 132701....
132701	23048	" " " " Handle.....
330W	23048	" " " " Screw.....
42028	23048	" " " (right) hinged.....
42101	23053	" " " " Lock Spring....
330W	23048	" " " " Screw.....
42029	23048	" Top Cover.....
132650	23053	" " " Extension.....
42102	23053	" " " " Holder.....
42324	-----	" " " " " 42102 with 42101, 42153, 132650 and two each 176D and 207D.....
283W	23053	Frame Top Cover Extension Holder Thumb Screw.....
19044	23053	Frame Top Cover Extension Holder Thumb Screw Washer.....
176D	23053	Frame Top Cover Extension Screw.....
742F	23048	" " " Screw.....

PARTS FOR MACHINE No. 81-3

No.	Plate	Name
42111	23051	Knife (movable).....
Note: Two No. 42111 are sent with this machine.		
42112	23051	Knife (movable) Gib.....
42035	23051	" " Holder.....
42113	-----	" " " 42035 with 133F, 42037, 42040, 42112 and two 404D....
42037	23051	Knife (movable) Holder Cap.....
404D	23051	" " " " Screw.....
42038	23051	" " " Guide with 336F..
42039	23051	" " " " Plate.....
621D	23051	" " " " " Screw
336F	23051	" " " " Set Screw..
133F	23051	" " " " Screw.....
42040	23051	" " " " Extension Pin.....
42041	23051	Knife (movable) Holder Spring.....
42042	23051	" " " Lever.....
42043	23047	" " " " Connection with two 175E.....
42369	-----	Knife (movable) Lever Connection 42043 with 1373C and 1520C.....
175E	23047	Knife (movable) Lever Connection Cap Screw.....
1373C	23047	Knife (movable) Lever Connection Hinge Screw.....
1520C	23047	Knife (movable) Lever Connection Hinge Screw Nut.....
42045	23051	Knife (movable) Lever Hinge Stud.....
1229C	23051	" " " " " Set Screw
42046	23051	" (stationary) with 42049.....
Note: Two No. 42046 are sent with this machine.		
42048	23051	Knife (stationary) Clamping Stud.....
1534D	23051	" " " " Thumb Nut
132766	23051	" " " Holder.....
1376C	23051	" " " " Regulating Thumb Screw.....
1101C	23051	Knife (stationary) Holder Screw.....
440C	23051	" " " " Stop Screw....
1547J	23051	" " " " " Nut
42049	23051	" " " Stud.....
42114	23050	Looper (left hand).....
132870	23050	" " " " Lever with 50117C....
42318	-----	" " " " 132870 with 42053
42052	23050	" " " " Connecting Link..
42384	-----	" " " " " "
42052 with two each 1520C and 50562C		
50562C	23050	Looper (left hand) Lever Connecting Link Hinge Screw.....
1520C	23050	Looper (left hand) Lever Connecting Link Hinge Screw Nut.....

No.	Plate	Name
42053	23050	Looper (left hand) Lever Hinge Stud.....
1036C	23050	" " " " " " Set Screw.....
50117C	23050	Looper (left hand) Set Screw.....
42166	23050	" (right hand).....
42073	23050	" " " and Spreader Lever with 1259C.....
42330	-----	Looper (right hand) and Spreader Lever 42073 with 233D, 42078 and 42242....
42074	23047	Looper (right hand) and Spreader Lever Ball Stud.....
1259C	23050	Looper (right hand) and Spreader Lever Ball Stud Set Screw.....
42075	23047	Looper (right hand) and Spreader Lever Connection with four 896C.....
42416	-----	Looper (right hand) and Spreader Lever Connection 42075 with 42074.....
42382	-----	Looper (right hand) and Spreader Lever Connection 42416 with 42025.....
42380	23047	Looper (right hand) and Spreader Lever Connection 42382 with 171E and 42077
896C	23047	Looper (right hand) and Spreader Lever Connection Cap Screw.....
42077	23047	Looper (right hand) and Spreader Lever Connection Guide.....
171E	23047	Looper (right hand) and Spreader Lever Connection Guide Screw.....
42106	23053	Looper (right hand) and Spreader Lever Connection Oil Tube and Bracket with 29599.....
29599	23053	Looper (right hand) and Spreader Lever Connection Oil Tube Packing (felt)..
42078	23050	Looper (right hand) and Spreader Lever Hinge Pin.....
42079	23050	Looper (right hand) and Spreader Lever Hinge Pin Bushing.....
1259C	23050	Looper (right hand) and Spreader Lever Hinge Pin Bushing Set Screw.....
197D	23050	Looper (right hand) Screw.....
42054	23050	Needle Bar.....
42253	23050	" " Bushing.....
462C	23050	" " " Set Screw.....
42061	23050	" " Connecting Bracket with 187D and 223F.....
187D	23050	Needle Bar Connecting Bracket Clamping Screw.....
42055	23050	Needle Bar Connecting Link.....
42335	-----	" " " " 42055 with 42061, 42104 and two 40247.....
40247	23050	Needle Bar Connecting Link Hinge Pin....

PARTS FOR MACHINE No. 81-3

No.	Plate	Name
223F	23050	Needle Bar Connecting Link Hinge Pin Set Screw for 42061.....
904C	23050	Needle Bar Connecting Link Hinge Pin Set Screw for 42104.....
42057	23047	Needle Bar Connecting Rod with four 896C
42383	-----	" " " " 42057 with 42074.....
42374	-----	Needle Bar Connecting Rod 42383 with 42023.....
896C	23047	Needle Bar Connecting Rod Cap Screw....
42077	23047	" " " " Guide.....
171F	23047	" " " " " Screw...
42103	23050	" " Crank (back) with 1258C and two 1259C.....
42074	23047	Needle Bar Crank (back) Ball Stud.....
1259C	23050	" " " " " " Set Screw.....
1259C	23050	Needle Bar Crank (back) Position Screw..
1258C	23050	" " " " Set Screw.....
42104	23050	" " " (front) with 904C, 1258C and 1259C.....
1259C	23050	Needle Bar Crank (front) Position Screw..
1258C	23050	" " " " Set Screw.....
42105	23050	" " " Shaft.....
42487	23050	" " " " Bushing.....
624C	23050	" " " " " Set Screw
42115	23050	" " Thread Retainer Bracket.....
228D	23050	" " " " " Screw
42483	23050	" " " " Disc.....
93C	23050	" " " " Screw.....
10107	23050	" " " " Spring.....
1728C	23050	" Clamping Nut.....
42066	23051	" Guard.....
171F	23051	" " Screw.....
42157	23052	Presser Foot Body.....
42158	23052	" " Chaining-off Finger (narrow bight).....
42190	23055	Presser Foot Chaining-off Finger (wide bight).....
42500	23052	Presser Foot Chaining-off Finger for 132663.....
42288	23055	Presser Foot Chaining-off Finger for 1/16 in. bight.....
233J	23052	Presser Foot Chaining-off Finger Screw..
9320	23052	" " Hinge Pin.....
42159	23052	" " Plate.....
42405	23052	" " Plate.....
14058	23052	" " Spring.....
42160	23052	" " " Adjusting Pin.....
464C	23052	" " " " " Set Screw.....

PARTS FOR MACHINE No. 81-3

11

No.	Plate	Name
42161	23052	Presser Foot (spring hinged) complete for 42149 and 42152, Nos. 233J, 464C, 9320, 14058 and 42157 to 42160.....
132663	23052	Presser Foot (hinged) complete, Nos. 233J, 464C, 9320, 14058, 42157, 42160, 42405 and 42500.....
1324C	23051	Presser Foot Screw.....
39541	23051	" " " Washer.....
42069	23051	" Lever.....
42376	-----	" " 42069 with 42045.....
42045	23051	" " Hinge Stud.....
1120C	23051	" " " " Set Screw.....
42070	23051	" " Lifter.....
85D	23051	" " " Hinge Screw.....
1377C	23051	" " Screw Stud (eccentric)....
1547J	23051	" " " " Nut.....
42071	23051	" " Spring.....
1378D	23051	Pressure Regulating Thumb Screw.....
132631	23050	Spreader.....
197D	23050	" Screw.....
2102	23053	Tension (looper, left hand) Disc.....
1560C	23053	" " " " Regulating Thumb Nut.....
828C	23053	Tension (looper, left hand) Screw Stud..
42418	-----	" " " " " " 828C with 1560C.....
42121	23053	Tension (looper, left hand) Spring.....
2102	23053	" (looper, right hand) Disc.....
1560C	23053	" " " " Regulating Thumb Nut.....
828C	23053	Tension (looper, right hand) Screw Stud..
42418	-----	" " " " " " 828C with 1560C.....
10148	23053	Tension (looper, right hand) Spring....
17547	23053	" " " " Thread Guide
2102	23053	" (needle thread) Disc.....
1560C	23053	" " " Regulating Thumb Nut.....
916C	23053	Tension (needle thread) Screw Stud.....
44209	-----	" " " " " " 916C with 1560C.....
10148	23053	Tension (needle thread) Spring.....
42082	23053	" " " Thread Guide....
42242	23050	Thread (looper, left hand) Eyelet.....
233D	23050	" " " " " Screw.
42084	23050	" " " " Tube.....
462C	23050	" " " " Set Screw
42093	23050	" (looper, right hand) Staple.....
190D	23050	" " " " " Screw
42127	23050	" " " " Take-up.....

PARTS FOR MACHINE No. 81-3

No.	Plate	Name
197D	23050	Thread (looper, right hand) Take-up Screw.....
42096	23050	Thread (needle) Eyelet.....
217J	23050	" " " Screw.....
42162	23050	" " Take-up.....
197D	23050	" " " Screw.....
42163	23052	Throat Plate for 42149 and 42152.....
742F	23052	" " Screw.....

**Genuine Singer Needles should be used
in Singer Machines.
These Needles and their Containers
are marked with the
Company's Trade Mark "SIMANCO." 1**

**Needles in Containers marked
"For Singer Machines"
are not Singer made needles. 2**

MACHINE No. 81-4

DIFFERS FROM MACHINE No. 81-3 IN
HAVING HAND LEVER FOR QUICK
ADJUSTMENT OF BIGHT

THIS MACHINE IS THE SAME AS NO. 81-3
WITH THE FOLLOWING EXCEPTIONS:

No.	Plate	Name
*42173	-----	Frame, in place of 42022.....
42200	23054	Knife (stationary) Holder Regulating Lever.....
42322	-----	Knife (stationary) Holder Regulating Lever 42200 with 35C, 1250F and 42177
42176	23054	Knife (stationary) Holder Regulating Lever Friction Washer.....
42204	23054	Knife (stationary) Holder Regulating Lever Indicator.....
236F	23054	Knife (stationary) Holder Regulating Lever Indicator Screw.....
42201	23054	Knife (stationary) Holder Regulating Lever Latch.....
42321	-----	Knife (stationary) Holder Regulating Lever Latch 42201 with 1240F and 42202.....
42202	23054	Knife (stationary) Holder Regulating Lever Latch Bracket.....
213F	23054	Knife (stationary) Holder Regulating Lever Latch Bracket Screw.....
1240F	23054	Knife (stationary) Holder Regulating Lever Latch Hinge Screw.....
42203	23054	Knife (stationary) Holder Regulating Lever Latch Spring.....
42177	23054	Knife (stationary) Holder Regulating Lever Slide Block.....
1250F	23054	Knife (stationary) Holder Regulating Lever Slide Block Screw Stud.....
35C	23054	Knife (stationary) Holder Screw, in place of 1101C.....
42178	23054	Presser Foot Body, in place of 42157....
42179	23054	" " Chaining-off Finger, in place of 42158.....
42180	23054	Presser Foot Chaining-off Finger Regu- lating Lever.....

PARTS FOR MACHINE No. 81-4

No.	Plate	Name
104C	23054	Presser Foot Chaining-off Finger Regulating Lever Hinge Screw.....
42181	23054	Presser Foot (spring hinged) complete, Nos. 104C, 464C, 9320, 14058, 42159, 42160 and 42178 to 42180, in place of 42161.....
42164	23054	Throat Plate for 42149 and 42152, for narrow bight on balbriggan and closely woven goods, in place of 42163...

ACCESSORIES

No.	Plate	Name
1407E	23043	Machine Base Thumb Screw, for 3 in. table
1408E	23043	" " " " " 2 in. table
14063	23043	" " " " Spring.....
9842	23043	" " " " Washer.
120344	23043	Oiler (copper plated) with 120345.....
120345	23043	" Spout 4 1/2 in. long.....
120440	23043	Screw Driver 7 1/4 in. blade.....
42090	23043	Threading Wire.....
120341	23043	Tweezers (curved).....
42089	23043	Wrench for 1324, 1374 and 1728.....
8908	23043	" " 1520 and 1655.....
4822	23043	" " 1547.....

FITTINGS

FOR 81-3 MACHINE

FOR BALBRIGGAN

No.	Plate	Name
42149	23055	Feed (back) Dog, 3 teeth (16 teeth to the inch) for 42164.....
42262	23055	Feed (front) Dog, 21 teeth (16 teeth to the inch) for 42164.....
42158	23055	Presser Foot Chaining-off Finger (narrow bight).....
42190	23055	Presser Foot Chaining-off Finger (wide bight).....
42288	23055	Presser Foot Chaining-off Finger for 1/16 in. bight.....
233J	23055	Presser Foot Chaining-off Finger Screw..
42159	23055	" " Plate (back).....

No.	Plate	Name
9320	23055	Presser Foot Plate (back) Hinge Pin.....
14058	23055	" " " " Spring.....
42160	23055	" " " " " Adjust- ing Pin.....
464C	23055	Presser Foot Plate (back) Spring Adjust- ing Pin Set Screw.....
42263	23055	Presser Foot Plate (front).....
42461	23055	" " " " Hinge Pin....
42264	23055	" " Shank.....
42265	23055	Presser Foot (spring hinged) complete, Nos. 233J, 464C, 9320, 14058, 42158 to 42160, 42263, 42264 and 42461....
42164	23055	Throat Plate for 42149 and 42262.....

FOR LIGHT AND MEDIUM WEIGHT KNIT GOODS

No.	Plate	Name
42149	23055	Feed (back) Dog, 3 teeth (16 teeth to the inch) for 42163.....
42152	23055	Feed (front) Dog, 17 teeth (16 teeth to the inch) for 42163.....
42157	23055	Presser Foot Body.....
42158	23055	" " Chaining-off Finger (narrow bight).....
42190	23055	Presser Foot Chaining-off Finger (wide bight).....
42288	23055	Presser Foot Chaining-off Finger for 1/16 in. bight.....
233J	23055	Presser Foot Chaining-off Finger Screw..
9320	23055	" " Hinge Pin.....
42159	23055	" " Plate.....
14058	23055	" " Spring.....
42160	23055	" " " Adjusting Pin.....
464C	23055	" " " " " Set Screw.....
42161	23055	Presser Foot (spring hinged) complete, Nos. 233J, 464C, 9320, 14058 and 42157 to 42160.....
42163	23055	Throat Plate for 42149 and 42152.....

FOOT LIFTER PARTS

No.	Plate	Name
6439	23057	Chain, 36 in. to 45 in. with 56864 and 56865.....
Note: When ordering No.6439, state length required.		
4879	23057	Chain Connecting Link.....

FOOT LIFTER PARTS

No.	Plate	Name
56864	23057	Chain Hook (large).....
56865	23057	" " (small).....
42130	23057	Lifting Lever.....
42131	23057	" " Bracket.....
1229C	23057	" " " Screw.....
1301D	23057	" " Hinge Screw.....
42132	23057	" " Spring.....
1148C	23057	" " Stop Screw.....
1547J	23057	" " " " Nut.....
4881	23057	Treadle.....
4882	23057	" Shaft.....
4883	23057	" Spring.....
4884	23057	" Stand.....
4885	23057	Treadle complete, Nos. 4879, 4881 to 4884 and two wood screws 1 in. No. 16....
42133	-----	Foot Lifter complete, Nos. 1301D, 4885, 6439, 42130 to 42132 and two each 1148C, 1229C and 1547J.....

KNEE LIFTER PARTS

No.	Plate	Name
42130	23057	Lifting Lever.....
42131	23057	" " Bracket.....
1229C	23057	" " " Screw.....
42142	23057	" " Connecting Rod.....
1301D	23057	" " Hinge Screw.....
42132	23057	" " Spring.....
1148C	23057	" " Stop Screw.....
1547J	23057	" " " " Nut.....
2763	23057	Rock Shaft.....
12242	23057	" " Hanger with two wood screws 1 in. No. 10.....
2765	23057	Rock Shaft Knee Arm.....
2766	23057	" " " " Hub with 356C.....
356C	23057	" " " " Set Screw.....
2768	-----	Rock Shaft Knee Arm complete, Nos. 2765 to 2767.....
2767	23057	Rock Shaft Knee Plate with 356C.....
356C	23057	" " " " Set Screw.....
6337	23057	" " Lifting Bracket with two 356C
7125	23057	" " " " Hook.....
356C	23057	" " " " Set Screw
356C	23057	" " " " Set Screw....
2770	23057	" " Stop Dog with 140219C.....
140219C	23057	" " " " Set Screw.....

KNEE LIFTER PARTS

17

No.	Plate	Name
42143	23057	Rock Shaft complete, Nos. 2763, 2768, 6337, 7125 and two each 2770 and 12242.....
42144	-----	Knee Lifter complete, Nos. 1301D, 42130 to 42132, 42142, 42143 and two each 1148C, 1229C and 1547J.....

KNIFE GRINDER

No.	Plate	Name
41326	23056	Emery Wheel.....
1508C	23056	" " Clamping Nut.....
41327	23056	" " Shaft.....
41328	23056	" " " Pulley with 1036C.....
1036C	23056	" " " " Set Screw.....
41513	23056	" " Washer.....
41329	23056	Frame with 1036C.....
878D	23056	" Oil Hole Stop Screw.....
41330	23056	Knife Holder with two 14222.....
150209	23056	" " 41330 with 970D, 41331, 41332 and two each 313C, 771D, 1519E, 41333 and 41334.....
41331	23056	Knife Holder Bracket with 157E.....
157E	23056	" " " Clamping Screw.....
42065	23056	" " " Hinge Stud.....
1036C	23056	" " " " " Set Screw.....
717C	23056	" " " Stop Screw.....
1520E	23056	" " " " " Nut.....
41333	23056	" " Clamp.....
41334	23056	" " " Spring.....
14222	23056	" " " Steady Pin.....
771D	23056	" " " Thumb Screw.....
970D	23056	" " Regulating Thumb Screw.....
313C	23056	" " Screw Center.....
1519E	23056	" " " " Nut.....
41332	23056	" " Spring.....
41335	23056	Knife Grinder complete, Nos. 717C, 1508C, 1520E, 41326 to 41329, 42065, 150209, two each 878D, 41513 and three wood screws 1 1/4 in. No. 12.....

MACHINE BASE

No.	Plate	Name
42086	23056	Machine Base with three wood screws 1 1/4 in. No. 12 and four each 935E, 4718, 42088 and 66707.....

MACHINE BASE

No.	Plate	Name
4718	23056	Machine Base Cushion (felt).....
42088	23056	" Cushion (felt).....
935E	23056	" " Screw.....
66707	23056	" " " Washer.....

THREAD UNWINDER

FOR THREE SPOOLS

No.	Plate	Name
225259	23058	Spool Rest (for one spool) with 201018C.
225257	23058	" " (for two spools) with 201018C
150203	23058	" " Cushion (felt).....
225388	23058	" " Rod.....
200383C	23058	" " Set Screw.....
201018C	23058	" " Set Screw.....
202490	23058	" " Stand with 200383C.....
225391	23058	Thread Guide.....
201696J	23058	" " Lock Nut.....
225326	23058	" " Position Cup.....
225324	23058	" " Rod with 208E and 225322...
208E	23058	" " " Screw.....
225322	23058	" " " Washer.....
259143	23058	Thread Unwinder complete, Nos. 201696J, 202490, 225257, 225259, 225324, 225326, 225388, three each 150203, 225391 and wood screws 7/8 in. No. 12.....
27739	23058	Thread Cone (wood) for large cones.....
225390	23058	" " Holder, for inverted cones..

Note: Nos. 27739 and 225390, are used with, but not included in 259143.

WELT GUIDE

FOR 81-3 MACHINE

No.	Plate	Name
42473	23055	Welt Guide.....
42474	23055	" " Hinge Pin.....
42475	23055	" " " (female half).....
42476	23055	" " " (male half).....
42477	23055	" " Rivet.....
42478	23055	" " Spring.....
132869	-----	" " " 42478 with 42475 and two 42477, for 42188.....

No.	Plate	Name
42188	23055	Welt Guide (hinged) complete, Nos. 42473, 42474, 42476, 132869 and two 42477..
42187	23055	Welt Guide (solid).....
42189	23055	" " Holder.....
42332	23055	" " " 42189 with 190D, 1117D, 1209C and 19044.....
1209C	23055	Welt Guide Holder Screw.....
19044	23055	" " " " Washer.....
1117D	23055	" " Regulating Thumb Screw.....
190D	23055	" " Screw.....

OBSOLETE PARTS

No.	Plate	Name
*42251	-----	Arm with two each 462C and 42253, use 42484.....
42027	-----	Frame Side Cover (left) with 19045, use 132560.....
19045	-----	Frame Side Cover (left) Handle for 42027
42030	-----	" Top Cover Extension, use 132650...
2749	-----	" " " " Holder Thumb Screw Washer, use 19044.....
42156	-----	Knife (stationary) Holder, use 132766...
42175	-----	" " " " Regulating Lever Indicator, for 81-4 Machine, use 42204.....
213F	-----	Knife (stationary) Holder Regulating Lever Indicator Screw, for 81-4 Machine, use 236F.....
42051	-----	Looper (left hand) Lever with 209H, use 132870.....
378C	-----	Looper (left hand) Lever Connecting Link Hinge Screw, use 50562C.....
209H	-----	Looper (left hand) Set Screw for 42051..
42072	-----	Spreader, use 132631.....
42083	-----	Threader (looper, left hand) Eyelet, use 42242.....

**Genuine Singer Needles should be used
in Singer Machines.
These Needles and their Containers
are marked with the
Company's Trade Mark "SIMANCO." 1**

**Needles in Containers marked
"For Singer Machines"
are not Singer made needles. 2**

NUMERICAL
LIST
OF PARTS

NUMERICAL LIST OF PARTS

No.	Plate	Name
35C	23054	Knife (stationary) Holder Screw for 42322, for 81-4 Machine.....
61C	23049	Feed (back) Bar Hinge Screw.....
85D	23051	Presser Lever Lifter Hinge Screw.....
93C	23050	Needle Bar Thread Retainer Screw.....
104C	23054	Presser Foot Chaining-off Finger Regu- lating Lever Hinge Screw for 42181..
133F	23051	Knife (movable) Holder Screw for 42113..
157E	23049	Feed (front) Rock Shaft Crank Clamping Screw for 42021.....
157E	23056	Knife Grinder Knife Holder Bracket Clamping Screw for 41331.....
171E	23047	Looper (right hand) and Spreader Lever Connection Guide Screw for 42380....
171F	23047	Needle Bar Connecting Rod Guide Screw...
171F	23051	" Guard Screw.....
175E	23047	Knife (movable) Lever Connection Cap Screw for 42043.....
176D	23053	Frame Top Cover Extension Screw for 42324.....
187D	23050	Needle Bar Connecting Bracket Clamping Screw for 42061.....
190D	23049	Feed (back) Regulator Set Screw.....
190D	23049	" (front) Dog Screw.....
190D	23050	Thread (looper, right hand) Staple Screw
190D	23055	Welt Guide Screw for 42332.....
197D	23050	Looper (right hand) Screw.....
197D	23050	Spreader Screw.....
197D	23050	Thread (looper, right hand) Take-up Screw.....
197D	23050	Thread (needle) Take-up Screw.....
203D	23049	Feed (back) Dog Screw.....
207D	23053	" (front) Eccentric Cover Screw for 42324.....
207D	23049	Feed (front) Regulator Indicator Screw..
208E	23058	Thread Unwinder Thread Guide Rod Screw for 225324.....
209H	-----	Looper (left hand) Set Screw for 42051, obsolete.....
213F	-----	Knife (stationary) Holder Regulating Lever Indicator Screw for 81-4 Ma- chine, obsolete, use 236F.....
213F	23054	Knife (stationary) Holder Regulating Lever Latch Bracket Screw for 81-4 Machine.....

NUMERICAL LIST OF PARTS

No.	Plate	Name
217J	23050	Thread (needle) Eyelet Screw.....
223F	23050	Needle Bar Connecting Link Hinge Pin Set Screw for 42061.....
228D	23050	Needle Bar Thread Retainer Bracket Screw
229E	23048	Cloth Plate Extension (lower) Screw for 42146.....
229E	23048	Cloth Plate Extension (upper) Screw for 42146.....
233J	23049	Feed (front) Regulator Stop Screw for 42014.....
233J	23052	Presser Foot Chaining-off Finger Screw for 42161, 42265 and 132663.....
233D	23050	Thread (looper, left hand) Eyelet Screw for 42330.....
236C	23048	Cloth Plate Lock Spring Screw for 42146.
236F	23054	Knife (stationary) Holder Regulating Lever Indicator Screw for 81-4 Ma- chine.....
283W	23053	Frame Top Cover Extension Holder Thumb Screw.....
313C	23056	Knife Grinder Knife Holder Screw Center for 150209.....
330W	23048	Frame Side Cover (left) Screw.....
330W	23048	" " " (right) Screw.....
336F	23051	Knife (movable) Holder Guide Set Screw for 42038.....
337D	23048	Feed (front) Regulator Indicator Plate Screw.....
356C	23057	Rock Shaft Knee Arm Hub Set Screw for 2766.....
356C	23057	Rock Shaft Knee Plate Set Screw for 2767
356C	23057	" " Lifting Bracket Hook Set Screw for 6337.....
356C	23057	Rock Shaft Lifting Bracket Set Screw for 6337.....
378C	-----	Looper (left hand) Lever Connecting Link Hinge Screw, obsolete, use 50562C...
404D	23051	Knife (movable) Holder Cap Screw for 42113.....
424C	23047	Balance Wheel Set Screw for 42001.....
440C	23051	Knife (stationary) Holder Stop Screw....
453C	23047	Feed (front) Eccentric Set Screw for 42011.....
462C	23047	Feed (front) Lifting Eccentric Set Screw for 42012.....
462C	23050	Needle Bar Bushing Set Screw for 42251 and 42484.....
462C	23050	Thread (looper, left hand) Tube Set Screw.....
464C	23055	Presser Foot Plate (back) Spring Adjust- ing Pin Set Screw for 42265.....

NUMERICAL LIST OF PARTS

23

No.	Plate	Name
464C	23052	Presser Foot Spring Adjusting Pin Set Screw for 42161, 42181 and 132663...
621D	23051	Knife (movable) Holder Guide Plate Screw
624C	23050	Needle Bar Crank Shaft Bushing Set Screw for 42484.....
717C	23056	Knife Grinder Knife Holder Bracket Stop Screw for 41335.....
742F	23048	Frame Top Cover Screw.....
742F	23052	Throat Plate Screw.....
771D	23056	Knife Grinder Knife Holder Clamp Thumb Screw for 150209.....
828C	23053	Tension (looper, left hand) Screw Stud for 42418.....
828C	23053	Tension (looper, right hand) Screw Stud for 42418.....
878D	23056	Knife Grinder Frame Oil Hole Stop Screw for 41335.....
896C	23047	Looper (right hand) and Spreader Lever Connection Cap Screw for 42075.....
896C	23047	Needle Bar Connecting Rod Cap Screw for 42057.....
904C	23050	Needle Bar Connecting Link Hinge Pin Set Screw for 42104.....
916C	23053	Tension (needle thread) Screw Stud for 44209.....
935E	23056	Machine Cushion Screw for 42086.....
949E	23047	Arm Screw.....
970D	23056	Knife Grinder Knife Holder Regulating Thumb Screw for 150209.....
1012E	23049	Feed (front) Regulator Connection Ad- justing Screw for 42015.....
1036C	23049	Feed (front) Rock Shaft Hinge Pin Bush- ing Set Screw.....
1036C	23047	Frame Rotary Shaft Bushing (front) Set Screw.....
1036C	23047	Frame Rotary Shaft Flanged Bushing (back) Set Screw.....
1036C	23056	Knife Grinder Emery Wheel Shaft Pulley Set Screw for 41328.....
1036C	23056	Knife Grinder Knife Holder Bracket Hinge Stud Set Screw for 41329.....
1036C	23050	Looper (left hand) Lever Hinge Stud Set Screw.....
1057C	23047	Feed (front) Connecting Rod Cap Screw for 42008.....
1101C	23051	Knife (stationary) Holder Screw for 81-3 Machine.....
1117D	23055	Welt Guide Regulating Thumb Screw for 42332.....
1120C	23051	Presser Lever Hinge Stud Set Screw.....

NUMERICAL LIST OF PARTS

No.	Plate	Name
1132C	23049	Feed (back) Connecting Link Hinge Screw.
1132C	23049	" " Regulator Hinge Screw.....
1148C	23057	Lifting Lever Stop Screw for 42133 and 42144.....
1209C	23055	Welt Guide Holder Screw for 42332.....
1229C	23051	Knife (movable) Lever Hinge Stud Set Screw.....
1229C	23057	Lifting Lever Bracket Screw for 42133 and 42144.....
1240F	23054	Knife (stationary) Holder Regulating Lever Latch Hinge Screw for 42321, for 81-4 Machine.....
1250F	23054	Knife (stationary) Holder Regulating Lever Slide Block Screw Stud for 42322, for 81-4 Machine.....
1253C	23049	Feed (front) Bar Hinge Pin Set Screw for 42151.....
1258C	23050	Needle Bar Crank (back) Set Screw for 42103.....
1258C	23050	Needle Bar Crank (front) Set Screw for 42104.....
1259C	23049	Feed (front) Regulator Set Screw for 42014.....
1259C	23047	Frame Rotary Shaft Crank Set Screw for 42025.....
1259C	23050	Looper (right hand) and Spreader Lever Ball Stud Set Screw for 42073.....
1259C	23050	Looper (right hand) and Spreader Lever Hinge Pin Bushing Set Screw.....
1259C	23050	Needle Bar Crank (back) Ball Stud Set Screw for 42103.....
1259C	23050	Needle Bar Crank (back) Position Screw for 42103.....
1259C	23050	Needle Bar Crank (front) Position Screw for 42104.....
1301D	23057	Lifting Lever Hinge Screw for 42133 and 42144.....
1324C	23051	Presser Foot Screw.....
1354C	23047	Balance Wheel Position Screw for 42001..
1373C	23047	Feed (front) Connecting Rod Hinge Screw for 42371.....
1373C	23049	Feed (front) Regulator Connection Hinge Screw for 42368.....
1373C	23047	Knife (movable) Lever Connection Hinge Screw for 42369.....
1374C	23049	Feed (front) Regulating Screw Stud.....
1375C	23047	Frame Rotary Shaft Crank Position Screw for 42025.....
1376C	23051	Knife (stationary) Holder Regulating Thumb Screw for 81-3 Machine.....

No.	Plate	Name
1377C	23051	Presser Lever Screw Stud (eccentric)....
1378D	23051	Pressure Regulating Thumb Screw.....
1407E	23043	Machine Base Thumb Screw, for 3 in. table (Accessories).....
1408E	23043	Machine Base Thumb Screw, for 2 in. table (Accessories).....
1437D	23048	Cloth Plate Hinge Screw.....
1444C	23049	Feed (back) Regulator Thumb Screw.....
1508C	23056	Knife Grinder Emery Wheel Clamping Nut for 41335.....
1519E	23056	Knife Grinder Knife Holder Screw Center Nut for 150209.....
1520C	23047	Feed (front) Connecting Rod Hinge Screw Nut for 42371.....
1520C	23049	Feed (front) Regulator Connection Hinge Screw Nut for 42368.....
1520E	23056	Knife Grinder Knife Holder Bracket Stop Screw Nut for 41335.....
1520C	23047	Knife (movable) Lever Connection Hinge Screw Nut for 42369.....
1520C	23050	Looper (left hand) Lever Connecting Link Hinge Screw Nut for 42384.....
1534D	23051	Knife (stationary) Clamping Stud Thumb Nut.....
1547J	23051	Knife (stationary) Holder Stop Screw Nut
1547J	23057	Lifting Lever Stop Screw Nut for 42133 and 42144.....
1547J	23051	Presser Lever Screw Stud Nut.....
1560C	23053	Tension (looper, left hand) Regulating Thumb Nut for 42418.....
1560C	23053	Tension (looper, right hand) Regulating Thumb Nut for 42418.....
1560C	23053	Tension (needle thread) Regulating Thumb Nut for 44209.....
1655E	23048	Cloth Plate Hinge Screw Nut.....
1680C	23049	Feed (front) Regulating Screw Stud Nut..
1728C	23050	Needle Clamping Nut.....
2102	23053	Tension (looper, left hand) Disc.....
2102	23053	" (looper, right hand) Disc.....
2102	23053	" (needle thread) Disc.....
2749	-----	Frame Top Cover Extension Holder Thumb Screw Washer, obsolete, use 19044...
2763	23057	Rock Shaft for 42143.....
2765	23057	" " Knee Arm for 2768.....
2766	23057	" " " " Hub with 356C, for 2768.....
2767	23057	Rock Shaft Knee Plate with 356C, for 2768
2768	-----	Rock Shaft Knee Arm complete for 42143, Nos. 2765 to 2767.....
2770	23057	Rock Shaft Stop Dog with 140219C, for 42143.....

NUMERICAL LIST OF PARTS

No.	Plate	Name
4389	23047	Arm Dowel Pin.....
4718	23056	Machine Base Cushion (felt) for 42086...
4822	23043	Wrench for 1547 (Accessories).....
4879	23057	Chain Connecting Link for 4885.....
4881	23057	Treadle for 4885.....
4882	23057	" Shaft for 4885.....
4883	23057	" Spring for 4885.....
4884	23057	" Stand for 4885.....
4885	23057	Treadle complete for 42133, Nos. 4879, 4881 to 4884 and two wood screws 1 in. No. 16.....
6337	23057	Rock Shaft Lifting Bracket with two 356C, for 42143.....
6439	23057	Chain, 36 in. to 45 in. with 56864 and 56865, for 42133.....
7125	23057	Rock Shaft Lifting Bracket Hook for 42143.....
8908	23043	Wrench for 1520 and 1655 (Accessories)
9320	23052	Presser Foot Hinge Pin for 42161, 42181 and 132663.....
9320	23055	Presser Foot Plate (back) Hinge Pin for 42265.....
9842	23043	Machine Base Thumb Screw Spring Washer (Accessories).....
10107	23050	Needle Bar Thread Retainer Spring.....
10148	23053	Tension (looper, right hand) Spring.....
10148	23053	" (needle thread) Spring.....
12242	23057	Rock Shaft Hanger with two wood screws 1 in. No. 10, for 42143.....
14058	23055	Presser Foot Plate (back) Spring for 42265.....
14058	23052	Presser Foot Spring for 42161, 42181 and 132663.....
14063	23043	Machine Base Thumb Screw Spring (Ac- cessories).....
14222	23056	Knife Grinder Knife Holder Clamp Steady Pin for 41330.....
17547	23053	Tension (looper, right hand) Thread Guide.....
19044	23053	Frame Top Cover Extension Holder Thumb Screw Washer.....
19044	23055	Welt Guide Holder Screw Washer for 42332
19045	-----	Frame Side Cover (left) Handle for 42027, obsolete.....
27739	23058	Thread Unwinder Thread Cone (wood) for large cones, for 259143.....
29599	23053	Looper (right hand) and Spreader Lever Connection Oil Tube Packing (felt) for 42106.....
39541	23051	Presser Foot Screw Washer.....

NUMERICAL LIST OF PARTS

27

No.	Plate	Name
40247	23050	Needle Bar Connecting Link Hinge Pin for 42335.....
41326	23056	Knife Grinder Emery Wheel for 41335.....
41327	23056	" " " " Shaft for 41335
41328	23056	" " " " Pulley with 1036C, for 41335.....
41329	23056	Knife Grinder Frame with 1036C, for 41335
41330	23056	" " Knife Holder with two 14222, for 150209.....
41331	23056	Knife Grinder Knife Holder Bracket with 157E, for 150209.....
41332	23056	Knife Grinder Knife Holder Spring for 150209.....
41333	23056	Knife Grinder Knife Holder Clamp for 150209.....
41334	23056	Knife Grinder Knife Holder Clamp Spring for 150209.....
41335	23056	Knife Grinder complete, Nos. 717C, 1508C, 1520E, 41326 to 41329, 42065, 150209, two each 878D, 41513 and three wood screws 1 1/4 in. No. 12.....
41513	23056	Knife Grinder Emery Wheel Washer for 41335.....
42001	23047	Balance Wheel, 2 3/16 in. pulley with 424C and 1354C.....
42003	23048	Cloth Plate Extension (lower) for 42146.
42005	23048	" " Lock Spring for 42146.....
42007	23049	Feed (front) Bar Hinge Pin.....
42008	23047	" " Connecting Rod with two 1057C, for 42371.....
42011	23047	Feed (front) Eccentric with two 453C....
42012	23047	" " Lifting Eccentric with two 462C.....
42013	23047	Feed (front) Lifting Eccentric Connection.....
42014	23049	Feed (front) Regulator with two each 233J and 1259C.....
42015	23049	Feed (front) Regulator Connection with 1012E, for 42368.....
42016	23049	Feed (front) Regulator Hinge Stud.....
42017	23049	" " " Indicator.....
42018	23048	" " " " Plate..
42021	23049	" " Rock Shaft Crank with 157E, for 42155.....
*42022	-----	Frame for 81-3 Machine.....
42023	23047	" Rotary Shaft for 42374.....
42024	23047	" " " Bushing (front).....
42025	23047	" " " Crank with 1259C and 1375C, for 42382.....
42026	23047	Frame Rotary Shaft Flanged Bushing (back) with 54967.....

NUMERICAL LIST OF PARTS

No.	Plate	Name
42027	-----	Frame Side Cover (left) with 19045, obsolete, use 132560.....
42028	23048	Frame Side Cover (right) hinged.....
42029	23048	" Top Cover.....
42030	-----	" " " Extension, obsolete, use 132650.....
42035	23051	Knife (movable) Holder for 42113.....
42037	23051	" " " Cap for 42113....
42038	23051	" " " Guide with 336F..
42039	23051	" " " " Plate.....
42040	23051	" " " Screw Extension Pin for 42113.....
42041	23051	Knife (movable) Holder Spring.....
42042	23051	" " Lever.....
42043	23047	" " " Connection with two 175E, for 42369.....
42045	23051	Knife (movable) Lever Hinge Stud.....
42045	23051	Presser Lever Hinge Stud for 42376.....
42046	23051	Knife (stationary) with 42049.....
42048	23051	" " Clamping Stud.....
42049	23051	" " Stud for 42046.....
42051	-----	Looper (left hand) Lever with 209H, obsolete, use 132870.....
42052	23050	Looper (left hand) Lever Connecting Link for 42384.....
42053	23050	Looper (left hand) Lever Hinge Stud for 42318.....
42054	23050	Needle Bar.....
42055	23050	" " Connecting Link for 42335....
42057	23047	" " " Rod with four 896C, for 42383.....
42061	23050	Needle Bar Connecting Bracket with 187D and 223F, for 42335.....
42065	23056	Knife Grinder Knife Holder Bracket Hinge Stud for 41335.....
42066	23051	Needle Guard.....
42069	23051	Presser Lever for 42376.....
42070	23051	" " Lifter.....
42071	23051	" " Spring.....
42072	-----	Spreader, obsolete, use 132631.....
42073	23050	Looper (right hand) and Spreader Lever with 1259C, for 42330.....
42074	23047	Looper (right hand) and Spreader Lever Ball Stud for 42416.....
42074	23047	Needle Bar Crank (back) Ball Stud for 42383.....
42075	23047	Looper (right hand) and Spreader Lever Connection with four 896C, for 42416
42077	23047	Looper (right hand) and Spreader Lever Connection Guide for 42380.....

NUMERICAL LIST OF PARTS

29

No.	Plate	Name
42077	23047	Needle Bar Connecting Rod Guide.....
42078	23050	Looper (right hand) and Spreader Lever Hinge Pin for 42330.....
42079	23049	Feed (front) Rock Shaft Hinge Pin Bush- ing.....
42079	23050	Looper (right hand) and Spreader Lever Hinge Pin Bushing.....
42082	23053	Tension (needle thread) Thread Guide....
42083	-----	Thread (looper, left hand) Eyelet, ob- solete, use 42242.....
42084	23050	Thread (looper, left hand) Tube.....
42086	23056	Machine Base with three wood screws 1 1/4 in. No. 12 and four each 935E, 4718, 42088 and 66707.....
42088	23056	Machine Cushion (felt) for 42086.....
42089	23043	Wrench for 1324, 1374 and 1728 (Accesso- ries).....
42090	23043	Threading Wire (Accessories).....
42093	23050	Thread (looper, right hand) Staple.....
42096	23050	" (needle) Eyelet.....
42098	23049	Feed (front) Rock Shaft Hinge Pin.....
42101	23053	Frame Side Cover (right) Lock Spring for 42324.....
42102	23053	Frame Top Cover Extension Holder for 42324.....
42103	23050	Needle Bar Crank (back) with 1258C and two 1259C.....
42104	23050	Needle Bar Crank (front) with 904C, 1258C and 1259C, for 42335.....
42105	23050	Needle Bar Crank Shaft.....
42106	23053	Looper (right hand) and Spreader Lever Connection Oil Tube and Bracket with 29599.....
42108	23048	Cloth Plate Extension (upper) for 42146.
42111	23051	Knife (movable).....
42112	23051	" " G1b for 42113.....
42113	-----	" " Holder 42035 with 133F, 42037, 42040, 42112 and two 404D....
42114	23050	Looper (left hand).....
42115	23050	Needle Bar Thread Retainer Bracket.....
42121	23053	Tension (looper, left hand) Spring.....
42127	23050	Thread (looper, right hand) Take-up.....
42130	23057	Lifting Lever for 42133 and 42144.....
42131	23057	" " Bracket for 42133 and 42144
42132	23057	" " Spring for 42133 and 42144.
42133	-----	Foot Lifter complete, Nos. 1301D, 4885, 6439, 42130 to 42132 and two each 1148C, 1229C and 1547J.....
42142	23057	Lifting Lever Connecting Rod for 42144..
42143	23057	Rock Shaft complete for 42144, Nos. 2763, 2768, 6337, 7125 and two each 2770 and 12242.....

NUMERICAL LIST OF PARTS

No.	Plate	Name
42144	-----	Knee Lifter complete, Nos. 1301D, 42130 to 42132, 42142, 42143 and two each 1148C, 1229C and 1547J.....
*42145	-----	Cloth Plate for 42146.....
42146	23048	Cloth Plate complete, Nos. 42003, 42005, 42108, 42145, two 236C and five 229E.
42147	23049	Feed (back) Bar.....
42148	23049	" " Connecting Link.....
42149	23049	" " Dog, 3 teeth (16 teeth to the inch) for 42163 and 42164.....
42150	23049	Feed (back) Regulator.....
42151	23049	" (front) Bar with 1253C.....
42152	23049	" " Dog, 17 teeth (16 teeth to the inch) for 42163 and 42164.....
42153	23053	Feed (front) Eccentric Cover for 42324..
42154	23049	" " Rock Shaft for 42155.....
42155	-----	Feed (front) Rock Shaft complete, Nos. 42021 and 42154.....
42156	-----	Knife (stationary) Holder, obsolete, use 132766.....
42157	23052	Presser Foot Body for 42161 and 132663..
42158	23052	" " Chaining-off Finger (narrow bight) for 42161 and 42265.....
42159	23052	Presser Foot Plate for 42161 and 42181..
42159	23055	" " " (back) for 42265.....
42160	23055	" " " Spring Adjust- ing Pin for 42265.....
42160	23052	Presser Foot Spring Adjusting Pin for 42161, 42181 and 132663.....
42161	23052	Presser Foot (spring hinged) complete for 42149 and 42152, for 81-3 Machine, Nos. 233J, 464C, 9320, 14058 and 42157 to 42160.....
42162	23050	Thread (needle) Take-up.....
42163	23052	Throat Plate for 42149 and 42152, for 81-3 Machine.....
42164	23054	Throat Plate for 42149, 42152 and 42262, for narrow bight on balbriggan and closely woven goods.....
42166	23050	Looper (right hand).....
*42173	-----	Frame for 81-4 Machine.....
42175	-----	Knife (stationary) Holder Regulating Lever Indicator for 81-4 Machine, ob- solete, use 42204.....
42176	23054	Knife (stationary) Holder Regulating Lever Friction Washer for 81-4 Ma- chine.....
42177	23054	Knife (stationary) Holder Regulating Lever Slide Block for 42322, for 81-4 Machine.....

NUMERICAL LIST OF PARTS

31

No.	Plate	Name
42178	23054	Presser Foot Body for 42181.....
42179	23054	" " Chaining-off Finger for 42181
42180	23054	" " " " " Regulating Lever for 42181.....
42181	23054	Presser Foot (spring hinged) complete for 81-4 Machine, Nos. 104C, 464C, 9320,14058,42159,42160 and 42178 to 42180.....
42187	23055	Welt Guide (solid) for 81-3 Machine.....
42188	23055	Welt Guide (hinged) complete for 81-3 Machine, Nos. 42473, 42474, 42476, 132869 and two 42477.....
42189	23055	Welt Guide Holder for 42332.....
42190	23055	Presser Foot Chaining-off Finger (wide bight).....
42200	23054	Knife (stationary) Holder Regulating Lever for 42322, for 81-4 Machine...
42201	23054	Knife (stationary) Holder Regulating Lever Latch for 42321, for 81-4 Ma- chine.....
42202	23054	Knife (stationary) Holder Regulating Lever Latch Bracket for 42321, for 81-4 Machine.....
42203	23054	Knife (stationary) Holder Regulating Lever Latch Spring for 81-4 Machine.
42204	23054	Knife (stationary) Holder Regulating Lever Indicator for 81-4 Machine....
42242	23050	Thread (looper, left hand) Eyelet for 42330.....
*42251	-----	Arm with two each 462C and 42253, obso- lete, use 42484.....
42253	23050	Needle Bar Bushing for 42251 and 42484..
42262	23055	Feed (front) Dog, 21 teeth (16 teeth to the inch) for 42164, for 81-3 Ma- chine.....
42263	23055	Presser Foot Plate (front) for 42265....
42264	23055	" " Shank for 42265.....
42265	23055	Presser Foot (spring hinged) complete for 81-3 Machine, Nos. 233J, 464C, 9320,14058,42158 to 42160,42263, 42264 and 42461.....
42288	23055	Presser Foot Chaining-off Finger for 1/16 in. bight.....
42290	23049	Feed (front) Regulating Screw Stud Wash- er.....
42318	-----	Looper (left hand) Lever 132870 with 42053.....
42321	-----	Knife (stationary) Holder Regulating Lever Latch 42201 with 1240F and 42202, for 81-4 Machine.....

NUMERICAL LIST OF PARTS

No.	Plate	Name
42322	-----	Knife (stationary) Holder Regulating Lever 42200 with 35C, 1250F and 42177, for 81-4 Machine.....
42324	-----	Frame Top Cover Extension Holder 42102 with 42101, 42153, 132650 and two each 176D and 207D.....
42330	-----	Looper (right hand) and Spreader Lever 42073 with 233D, 42078 and 42242....
42332	23055	Welt Guide Holder 42189 with 190D, 1117D, 1209C and 19044, for 81-3 Ma- chine.....
42335	-----	Needle Bar Connecting Link 42055 with 42061, 42104 and two 40247.....
42367	23047	Frame Rotary Shaft Front Bearing Oil Pad (braided cotton).....
42368	-----	Feed (front) Regulator Connection 42015 with 1373C and 1520C.....
42369	-----	Knife (movable) Lever Connection 42043 with 1373C and 1520C.....
42371	-----	Feed (front) Connecting Rod 42008 with 1373C and 1520C.....
42374	-----	Needle Bar Connecting Rod 42383 with 42023.....
42376	-----	Presser Lever 42069 with 42045.....
42380	23047	Looper (right hand) and Spreader Lever Connection 42382 with 171E and 42077
42382	-----	Looper (right hand) and Spreader Lever Connection 42416 with 42025, for 42380.....
42383	-----	Needle Bar Connecting Rod 42057 with 42074, for 42374.....
42384	-----	Looper (left hand) Lever Connecting Link 42052 with two each 1520C and 50562C
42405	23052	Presser Foot Plate for 132663.....
42416	-----	Looper (right hand) and Spreader Lever Connection 42075 with 42074, for 42382.....
42418	-----	Tension (looper, left hand) Screw Stud 828C with 1560C.....
42418	-----	Tension (looper, right hand) Screw Stud 828C with 1560C.....
42461	23055	Presser Foot Plate (front) Hinge Pin for 42265.....
42473	23055	Welt Guide for 42188.....
42474	23055	" " Hinge Pin for 42188.....
42475	23055	" " " (female half) for 132869
42476	23055	" " " (male half) for 42188...
42477	23055	" " " Rivet for 42188 and 132869.....
42478	23055	Welt Guide Spring for 132869.....

NUMERICAL LIST OF PARTS

33

No.	Plate	Name
42483	23050	Needle Bar Thread Retainer Disc.....
*42484	-----	Arm with two each 462C, 624C, 42253 and 42487.....
42487	23050	Needle Bar Crank Shaft Bushing for 42484
42500	23052	Presser Foot Chaining-off Finger for 132663.....
44209	-----	Tension (needle thread) Screw Stud 916C with 1560C.....
50117C	23050	Looper (left hand) Set Screw for 132870.
50562C	23050	" " " Lever Connecting Link Hinge Screw for 42384.....
54967	23047	Frame Rotary Shaft Flanged Bushing (back) Oil Pad (braided cotton) for 42026.....
56864	23057	Chain Hook (large) for 6439.....
56865	23057	" " (small) for 6439.....
66707	23056	Machine Cushion Screw Washer for 42086..
120341	23043	Tweezers (curved) Accessories.....
120344	23043	Oiler (copper plated) with 120345 (Ac- cessories).....
120345	23043	Oiler Spout, 4 1/2 in. long for 120344..
120440	23043	Screw Driver, 7 1/4 in. blade (Accesso- ries).....
132560	23048	Frame Side Cover (left) with 132701....
132631	23050	Spreader.....
132650	23053	Frame Top Cover Extension for 42324....
132663	23052	Presser Foot (hinged) complete for 81-3 Machine, Nos. 233J, 464C, 9320, 14058, 42157, 42160, 42405 and 42500.....
132701	23048	Frame Side Cover (left) Handle for 132560.....
132766	23051	Knife (stationary) Holder.....
132869	-----	Welt Guide Spring 42478 with 42475 and two 42477, for 42188.....
132870	23050	Looper (left hand) Lever with 50117C, for 42318.....
140219C	23057	Rock Shaft Stop Dog Set Screw for 2770..
150203	23058	Thread Unwinder Spool Rest Cushion (felt) for 259143.....
150209	23056	Knife Grinder Knife Holder 41330 with 970D, 41331, 41332 and two each 313C, 771D, 1519E, 41333 and 41334, for 41335.....
200383C	23058	Thread Unwinder Spool Rest Rod Set Screw for 202490.....
201018C	23058	Thread Unwinder Spool Rest Set Screw for 225257 and 225259.....
201696J	23058	Thread Unwinder Thread Guide Lock Nut for 259143.....
202490	23058	Thread Unwinder Spool Stand with 200383C, for 259143.....

NUMERICAL LIST OF PARTS

No.	Plate	Name
225257	23058	Thread Unwinder Spool Rest (for two spools) with 201018C, for 259143....
225259	23058	Thread Unwinder Spool Rest (for one spool) with 201018C, for 259143.....
225322	23058	Thread Unwinder Thread Guide Rod Screw Washer for 225324.....
225324	23058	Thread Unwinder Thread Guide Rod with 208E and 225322, for 259143.....
225326	23058	Thread Unwinder Thread Guide Position Cup for 259143.....
225388	23058	Thread Unwinder Spool Rest Rod for 259143.....
225390	23058	Thread Unwinder Thread Cone Holder for inverted cones for 259143.....
225391	23058	Thread Unwinder Thread Guide for 259143.
259143	23058	Thread Unwinder complete for three spools, Nos. 201696J, 202490, 225257, 225259, 225324, 225326, 225388, three each 150203, 225391 and wood screws 7/8 in. No. 12.....

**Genuine Singer Needles should be used
in Singer Machines.
These Needles and their Containers
are marked with the
Company's Trade Mark "SIMANCO."** 1

**Needles in Containers marked
"For Singer Machines"
are not Singer made needles.** 2

**ILLUSTRATIONS
OF
PARTS**

23043 - 1/2

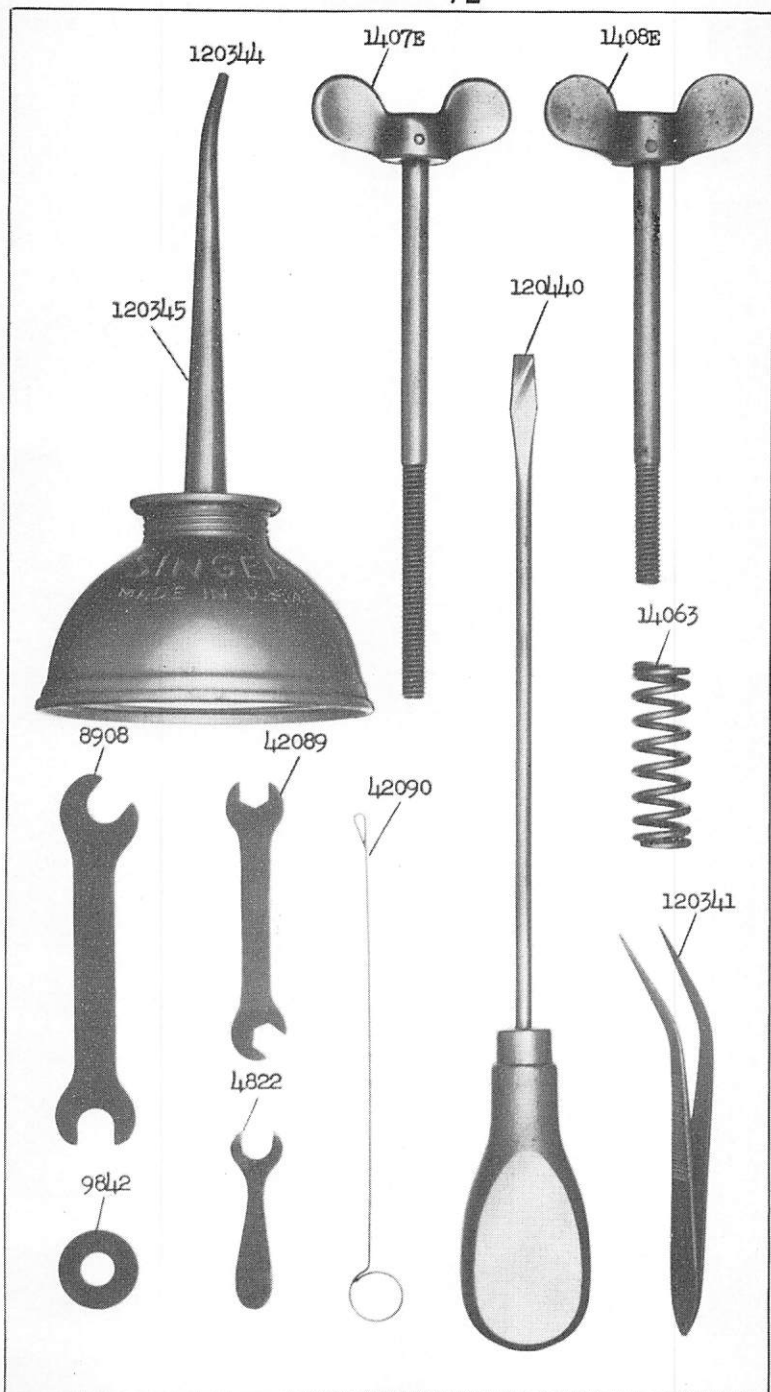

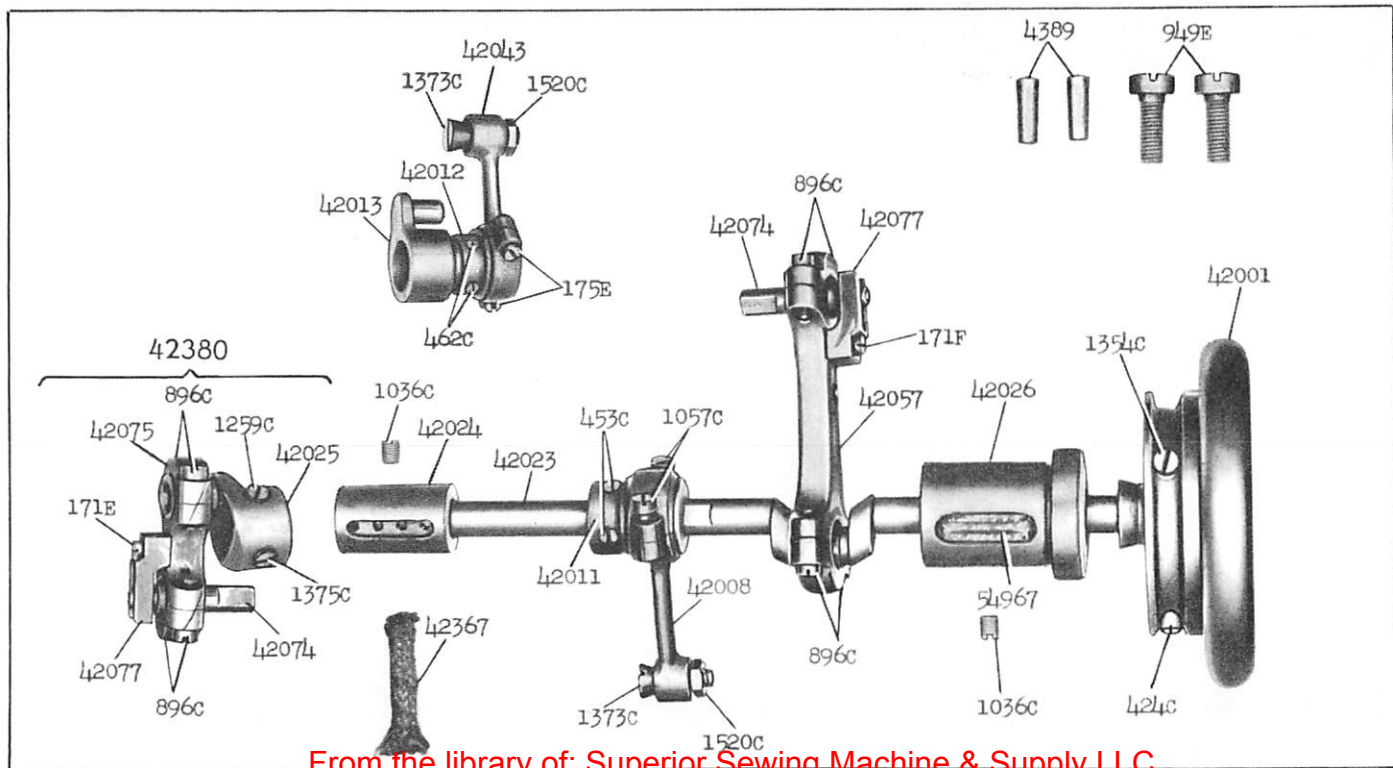

23047 - 1/2

From the library of: Superior Sewing Machine & Supply LLC

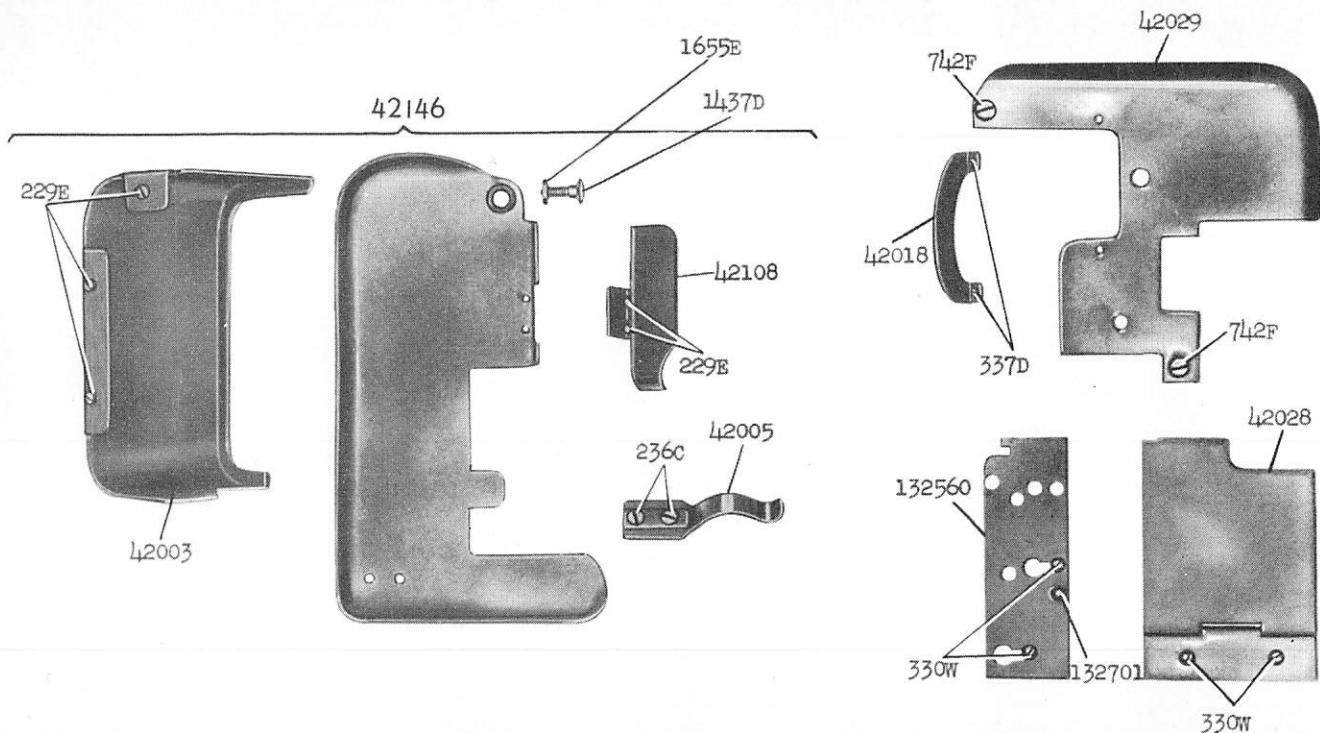

23048 - 1/3

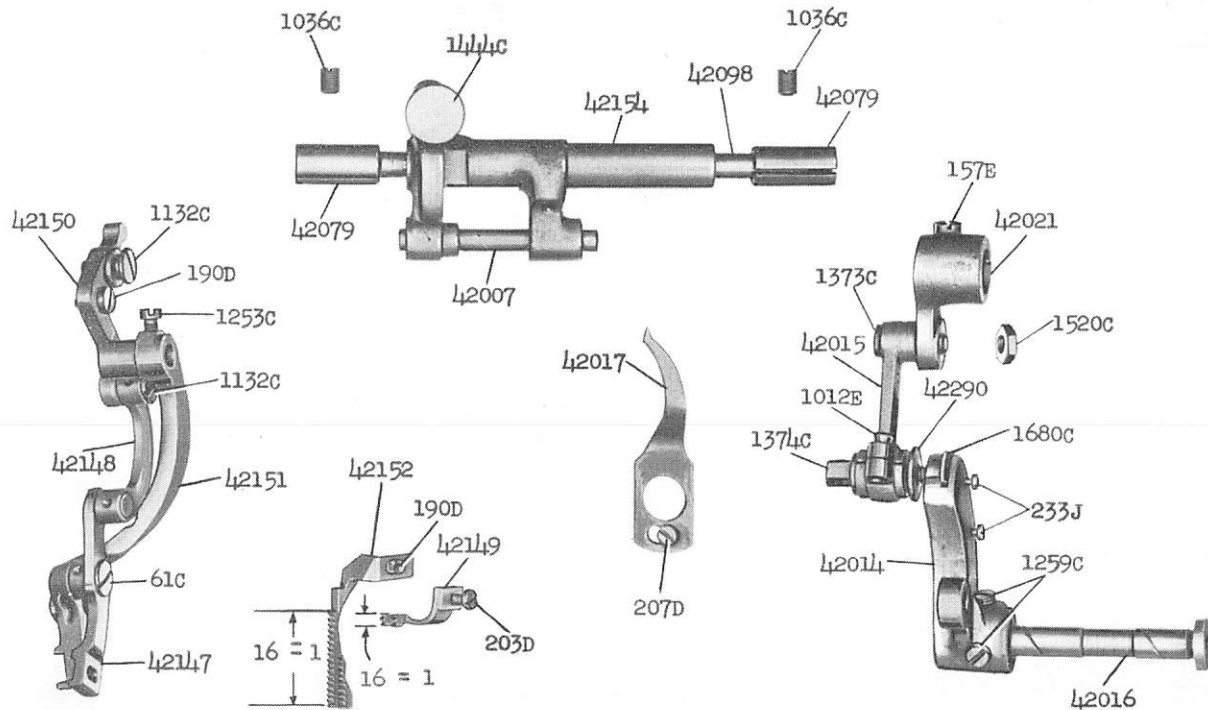

23051 - 1/2

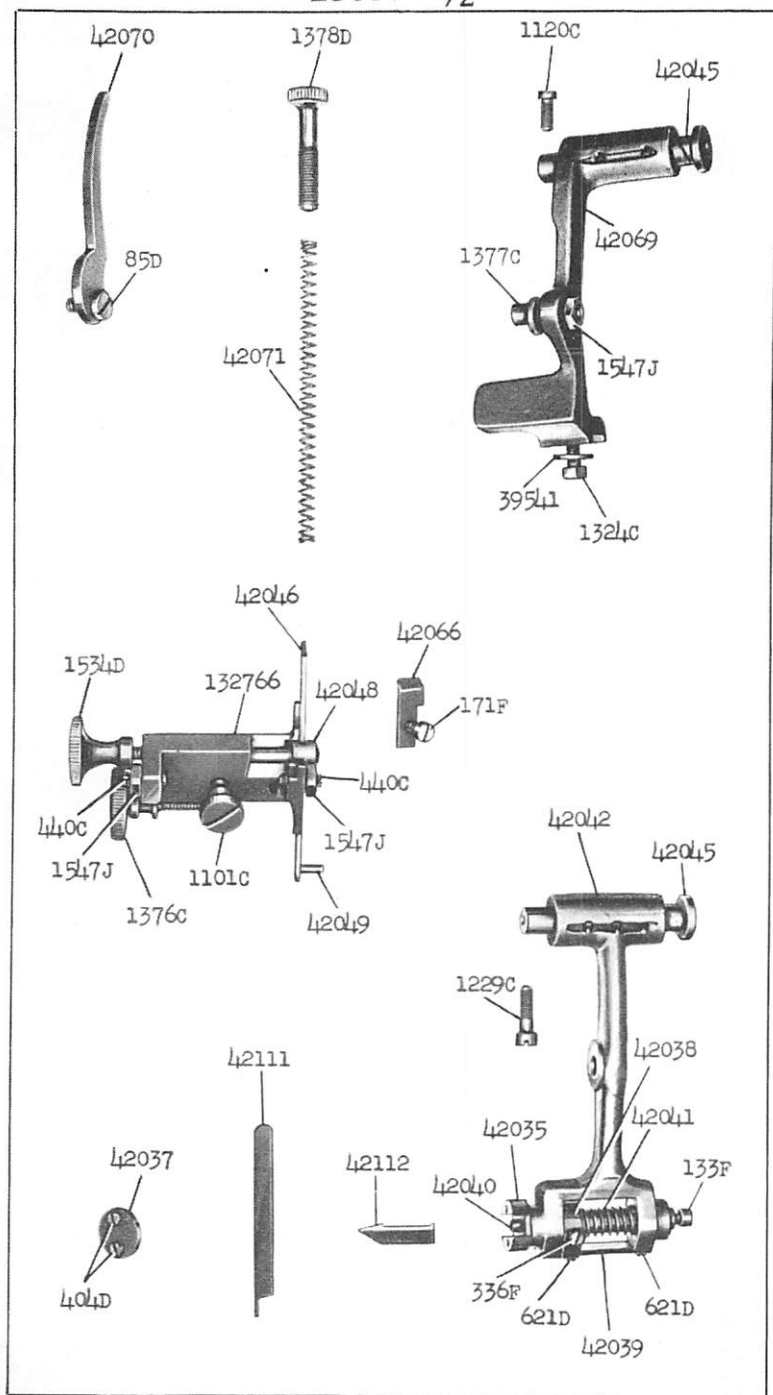

23052 - 2/3

(81-3)

42161

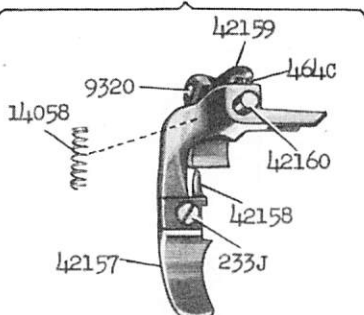

132663

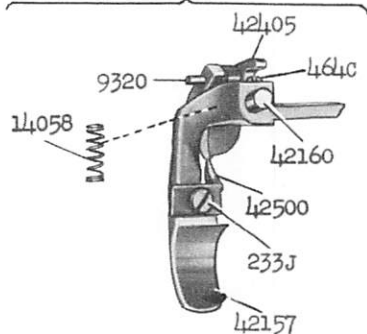

42163

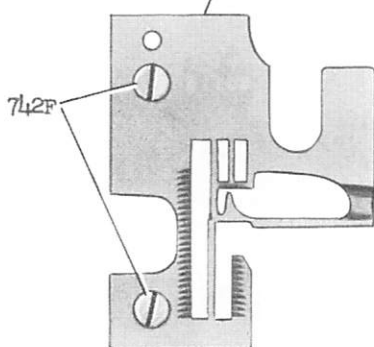

23053 - 1/2

1560c



42121



2102



42106

828c

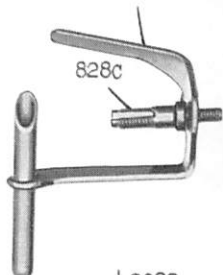

29599

42082

1560c



10148



2102



916c

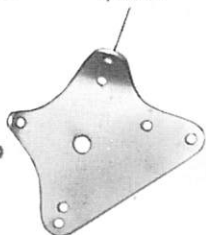

1560c



10148



2102



828c



17547

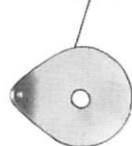

132650

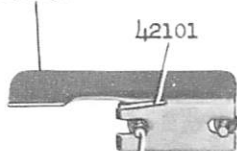

42101

176D

176D

283W

19044

42102

42153

207D

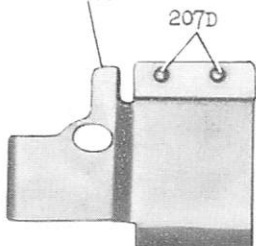

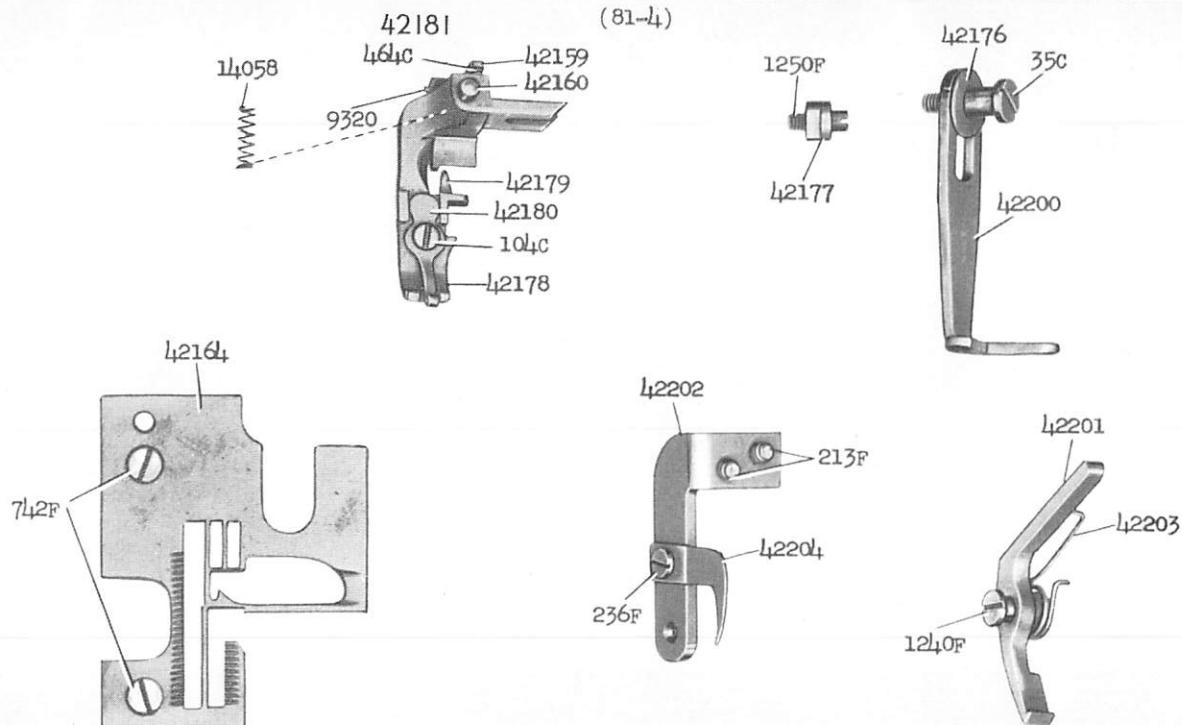

From the library of: Superior Sewing Machine & Supply LLC

23055 - 1/2

(81-3)

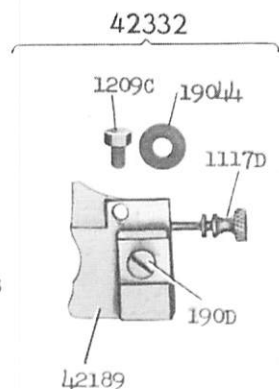
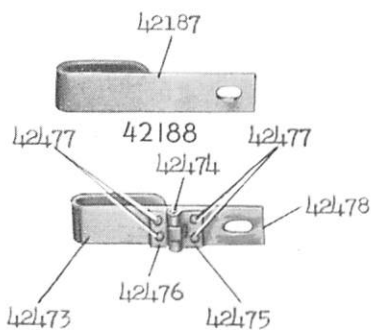
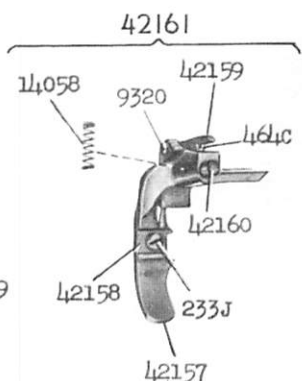
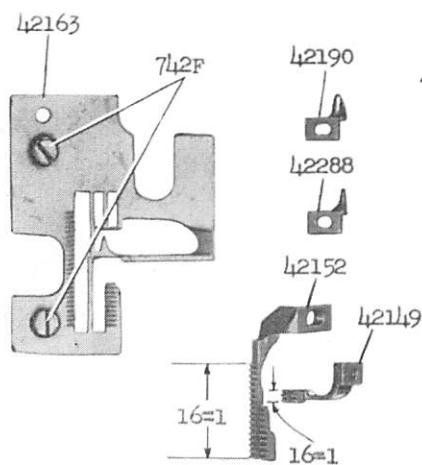
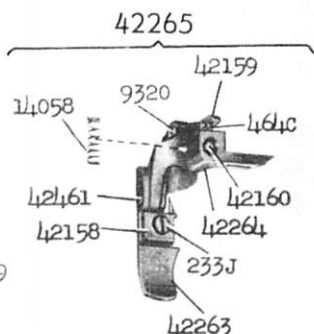
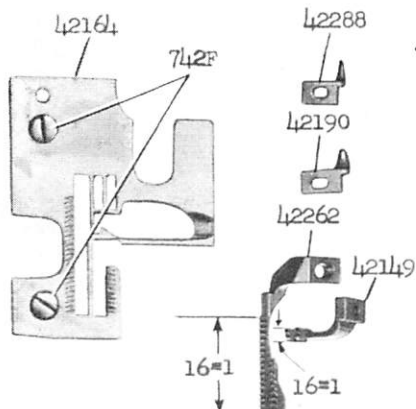

42086

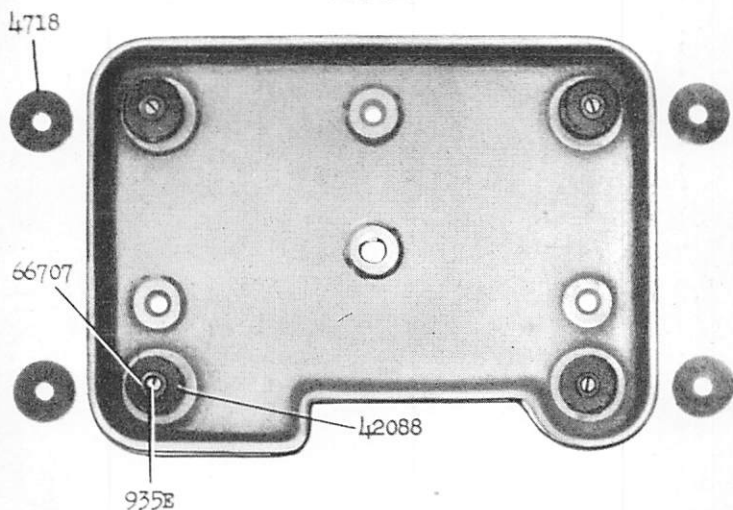

41335

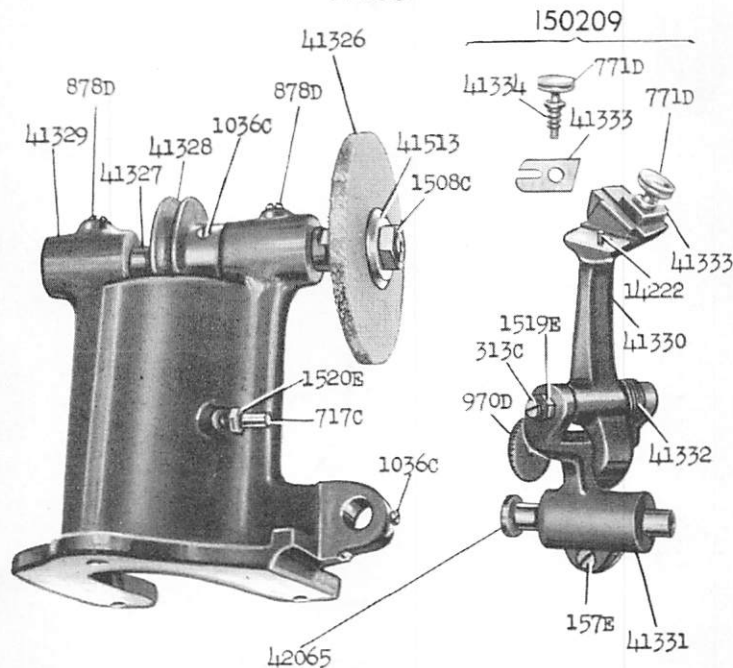

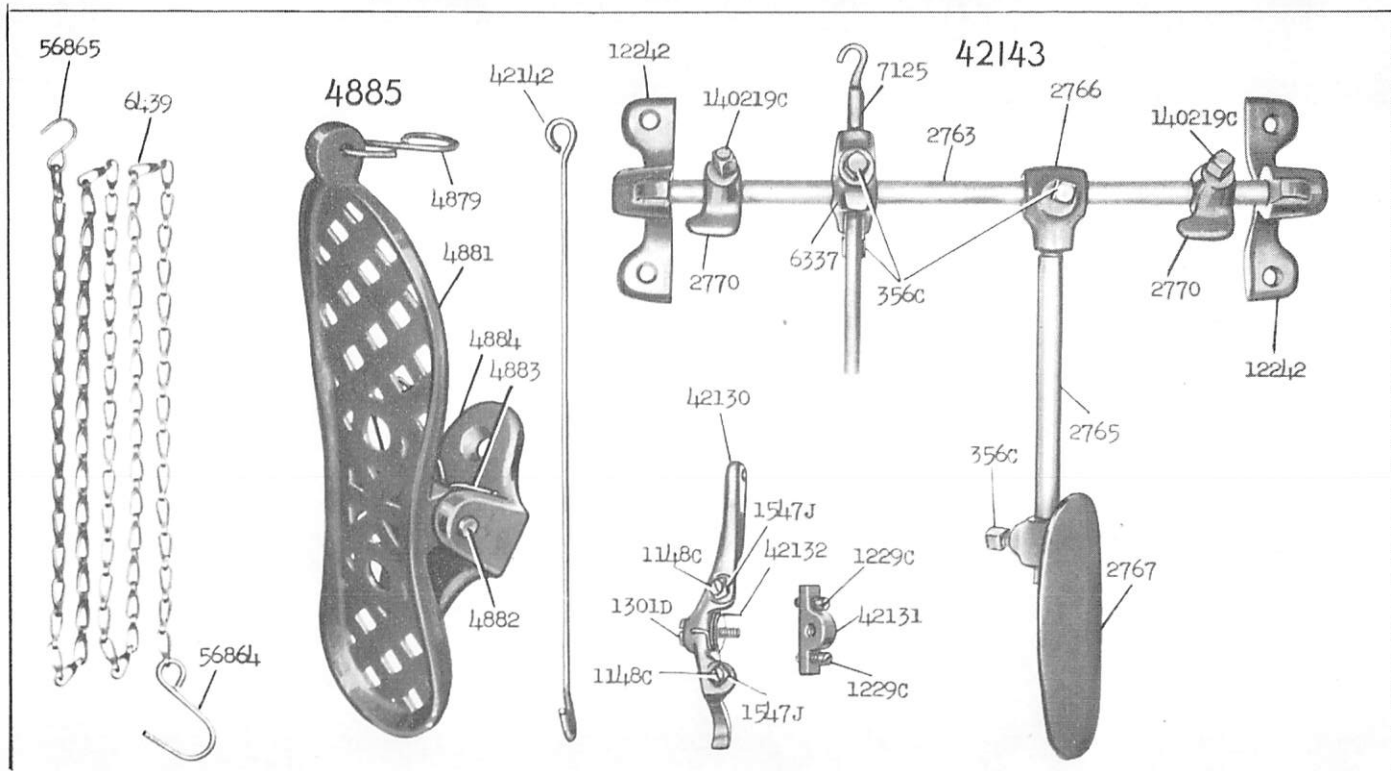

23057 - 1/3

From the library of: Superior Sewing Machine & Supply LLC

23058 - 1/4

259143

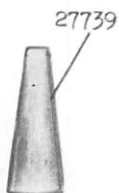
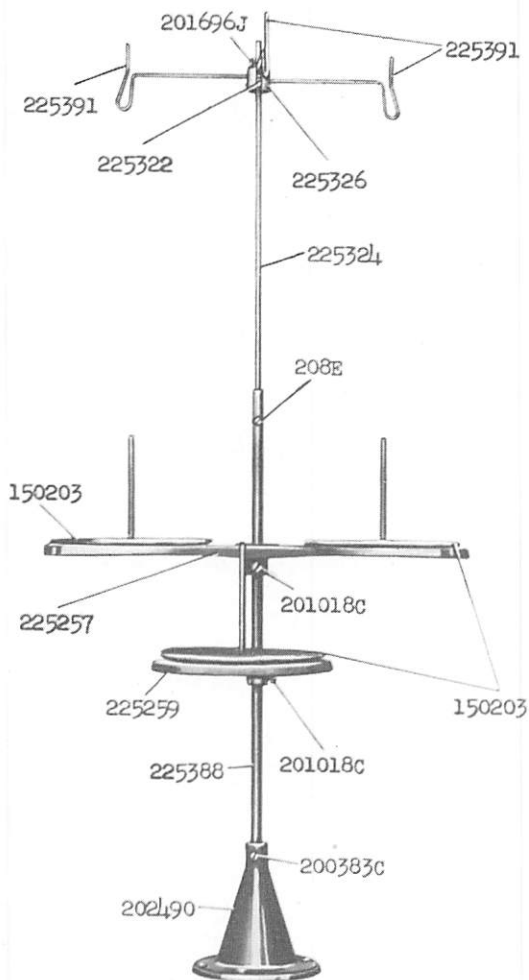

Genuine Singer Needles should be used
in Singer Machines.
These Needles and their Containers
are marked with the
Company's Trade Mark "SIMANCO." 1

Needles in Containers marked
"For Singer Machines"
are not Singer made needles. 2

